

TWO PIPE PROGRAMMABLE ROOM THERMOSTAT

Model: BAC-1000-ALN



Alpine white



Ultra black

In the box

- Thermostat: 1 pcs
- Wall Plate: 1 pcs
- Screws: 2 pcs
- User Guide: 1 pcs

Warranty

We offer a 18-MONTH warranty on the thermostat, starting with the date of the purchase. A claim must include a detailed report on the fault. If it is not a problem of quality or if the claim is filed after end of the warranty time, we can charge for the after-sale service.

Technical specifications

- Sensor: NTC
- Accuracy: $\pm 1^{\circ}\text{C}$
- Temperature range: 5 - 35°C
- Power consumption: <1.5W
- Timing error: <1%
- Power supply: 110-240V, 50-60Hz
- Current load: 1A Inductive, 2A Resistance
- Housing material: PC (Fireproof)
- Dimension: 86 x 86 x 13.3 mm
- Installation box: 86*86 mm / European 60 mm
- Ambient temp.: 0 ~ 45°C, 5-95% RH (Non condensing)
- Storage temp: -5°C ~ +55°C
- 4-pipe, 2-wire or 3-wire

- Clock
- Backlight
- RS485/Modbus RTU communication

Features

- Sleek flat design with a thin chrome frame.
- Acrylic surface against scratches and fingerprints.
- Simple operation through capacitive touch buttons.
- Large screen with white backlight enables easy reading even in the dark.
- Six time-schedule programs for maximum comfort and energy efficiency.
- One touch control for resetting all schedule programs at any time.
- Precise comfort control with 1°C temperature setting steps.
- Data memory when power is off.
- Easy installation (86 mm box or European 60 mm round box optional)

Display

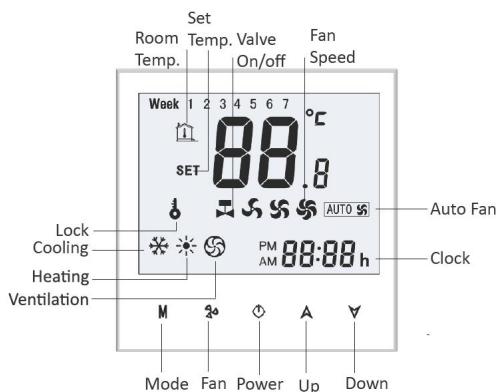

Settings

1. Setting the temperature

In Manual mode, press touch buttons "Up/Down A V" to set the temperature. The "SET" icon will be displayed in the display.

2. Locking the display (optional function)

Press and hold both A V for 3 seconds to lock the display. The key-shaped "Lock" icon will appear on the display. Press and hold A V for 3 seconds again to unlock the display.

3. Setting the fan

Press the "Fan" touch button to select fan speed: AUTO, HIGH, MED, LOW.

4. Setting the System mode

Press M to change the system mode HEATING, COOLING and VENTILATION. In VENTILATION mode, the valve is off but the fan runs.

5. Setting the Clock

Press and hold M to set Clock; Press M to set the minutes of the time, press A V to adjust the relative values. Same setting for hour and week of the time. After that, all will be confirmed automatically.

6. Setting functions and options

During power off, press and hold M and a touch buttons at the same time for 5 seconds to access system functions.

Then press M to change the different items.

Press A or V to set the relative values, press .

All the settings will confirm automatically when power is on.

No.	Function	Settings & Options	Default
1	Temp. Calibration	-9 to 9	-2
2	Fan Control	00: When room temp. reaches the setpoint, the fan will turn off. 01: When room temp. reaches the setpoint, the fan will turn to low speed.	00
3	Lock	00: All the buttons are locked except POWER 01: All the buttons are locked	00
4	Heating/Cooling	00: Cooling only 01: Heating/Cooling 02: Heating only	01
5	Min. Set Temp.	5-15°C	10
6	Max. Set Temp.	5-35°C	30
7	Display mode	00: Display both set temp. and room temp. 01: Display set temp. only	00
8	None		
9	None		
A	None		
B	Deadzone Temp.	1-5°C	1
C	None		
D	Modbus IP address	0x00-0xFF	1

Wiring the thermostat

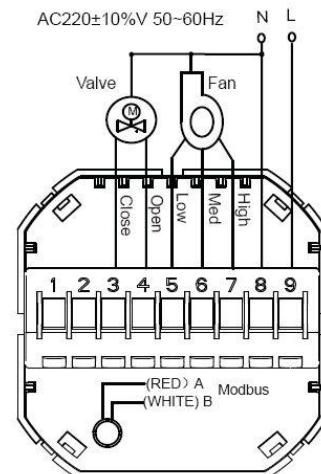

Mounting the thermostat

This thermostat is suitable for a standard 86 mm wall box or a European 60 mm round box.

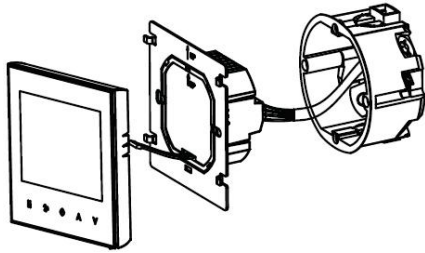

1. Connect the power wire and other equipment into the terminals.

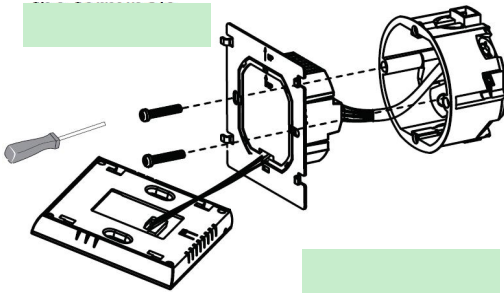

2. Fix the wall plate into the wall box with a screwdriver.

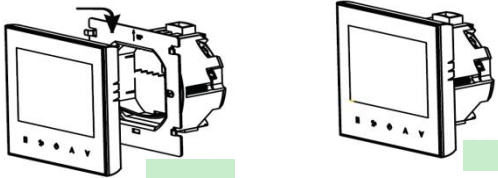

3. Slide the LCD board into the wall plate.

4. OK.

Summary

A microprocessor based RS485 Room Thermostat with capacitive touch buttons and an LCD display. Designed to on/off control the fans and valves in air conditioning applications, comparing the room temperature and the set temperature, thereby achieving comfort while saving energy.



WARNING: Please arrange a professional technician to install this product according to installation drawing and instruction.



RISK OF ELECTRICAL SHOCK! Disconnect power supply before making the electrical connection. Contact with components carrying hazardous voltage can cause electrical shock and may result in severe personal injury or death.

